

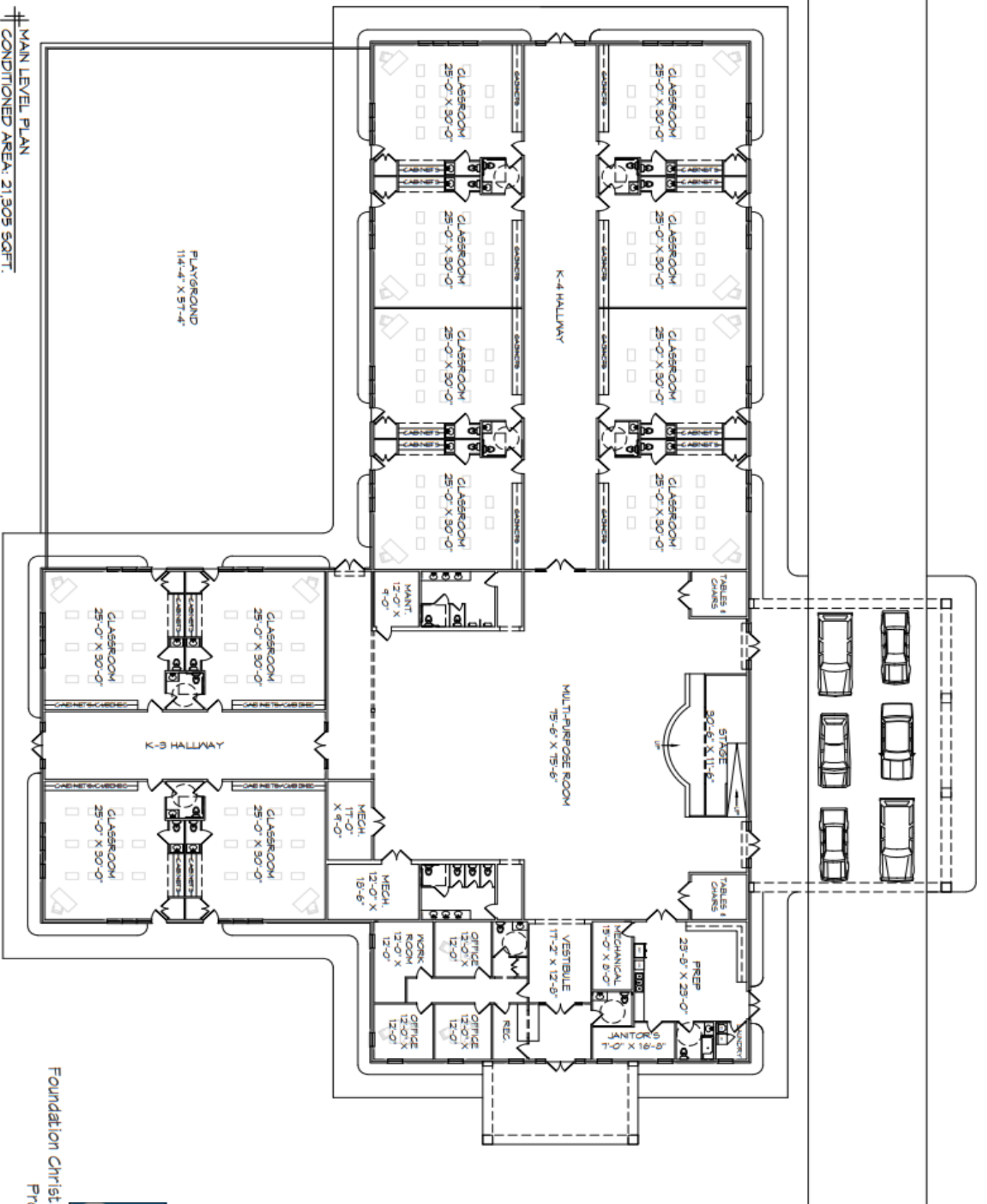

Foundation Christian Academy provides students a strong foundation of spiritual, intellectual, and social growth. Due to remarkable growth and interest, FCA has the need to build a separate building dedicated to preschool. This building designed for preschool students would permit the expansion of our program from 8 classrooms serving 106 students to 12 classrooms that would serve up to 160 students. This will let our elementary students move back into classrooms originally designed for them. It also allows for the middle school students to occupy the newest addition built during the 2021-2022 school year. The transition to a new preschool building will grant each division of the school the ability to move ***forward*** and have its own space, allowing for the expansion and growth of the school in all areas.



MAIN LEVEL PLAN
CONDITIONED AREA: 21,305 SQ.FT.



Foundation Christian Academy
Proposed Plan
12-08-2021
Scale: N.T.S.



The preschool building will be designed and built totally for preschool students. It will feature:

- * Multipurpose room where the preschool can have chapel, lunch, programs, and can be utilized when the weather is bad for indoor play.
- * The halls will be designed and decorated in such a way that preschool students will be excited to come to school.
- * There will be a courtyard attached to the building that allows a playground designed specifically for young children.
- * The drop-off and pick-up zone will be designed for safe and efficient arrival and departure from school.





In order to construct this building, the **FORWARD** campaign goal is \$3 million. It is the desire of the school to not go into debt nor have this building cost affect the tuition of our students in any way. Therefore, we are asking that you consider a two-year pledge to help FCA move **forward** in spreading God's love and making a difference in the lives of the students we serve.

